

## SAFARI BROWSER on an APPLE MAC COMPUTER

### HOW TO CLEAR THE CACHE:

---

#### **Why do I need to clear the cache?**

If you are having difficulties accessing the BMB website, this may be the result of what is called "browser caching".

This is where your web browser keeps copies of frequently visited web pages to reduce load times.

This caching works really well for pages that don't change but can cause problems with interactive websites such as Bernard Magee Bridge where content is frequently updated.

'Clearing the cache' normally resolved such issues.

This may also help to resolve any browser issues you have after a system or security update on your device.

You can clear the cache without deleting 'Saved Passwords / Log-in' or browser data.

---

# SAFARI BROWSER on an APPLE MAC COMPUTER

## HOW TO CLEAR THE CACHE:

### 1/ Open Safari

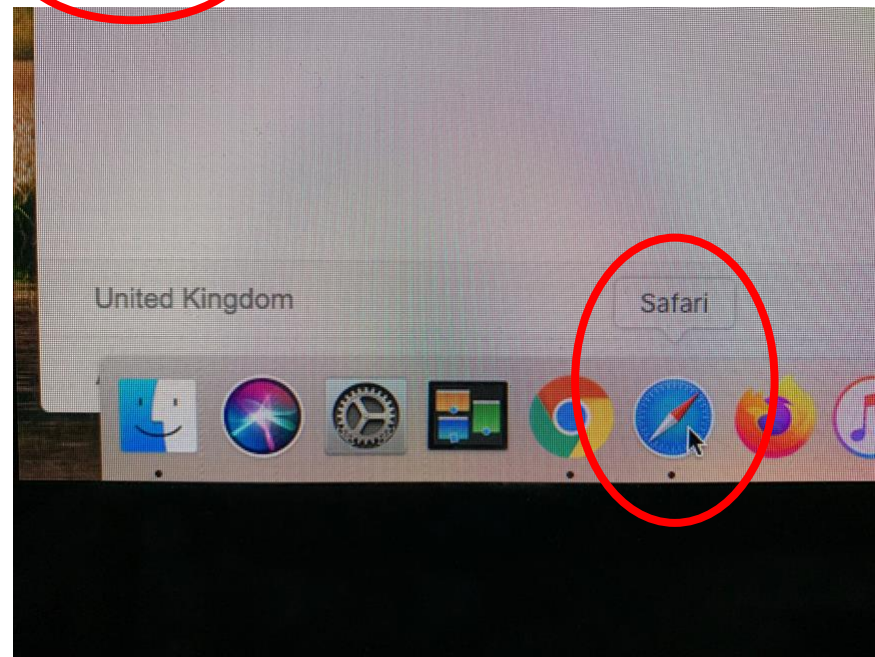

# SAFARI BROWSER on an APPLE MAC COMPUTER

## HOW TO CLEAR THE CACHE:

### 2/ Make sure you are logged out of bernardmageebridge.com

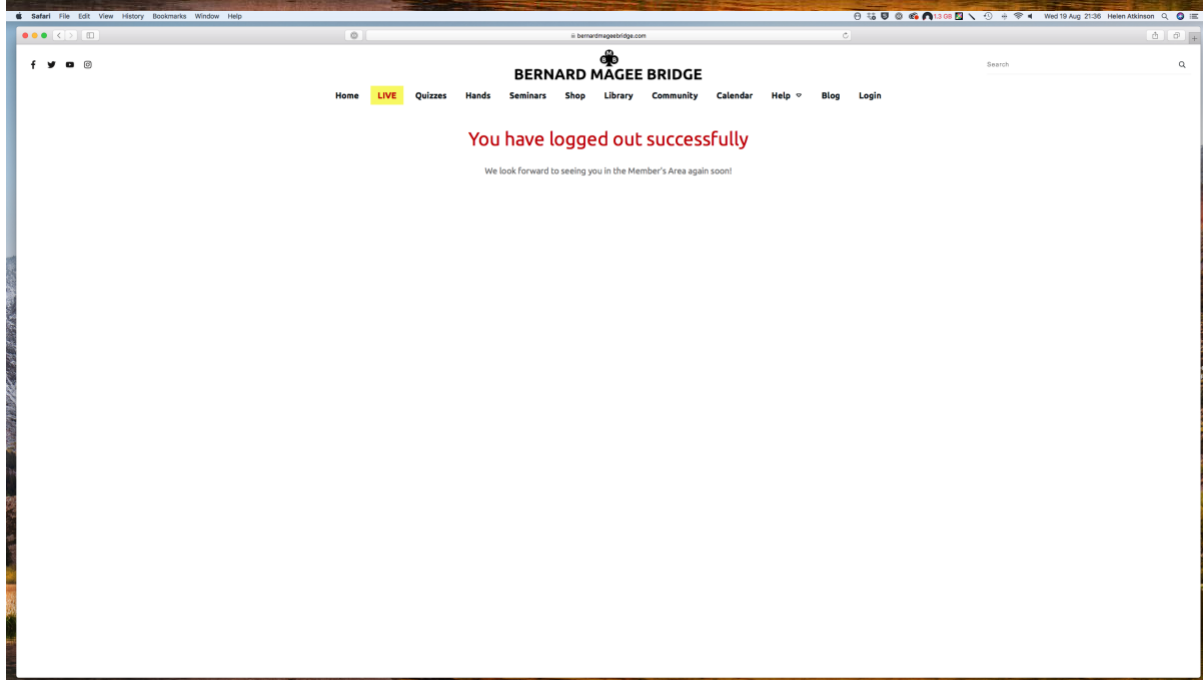
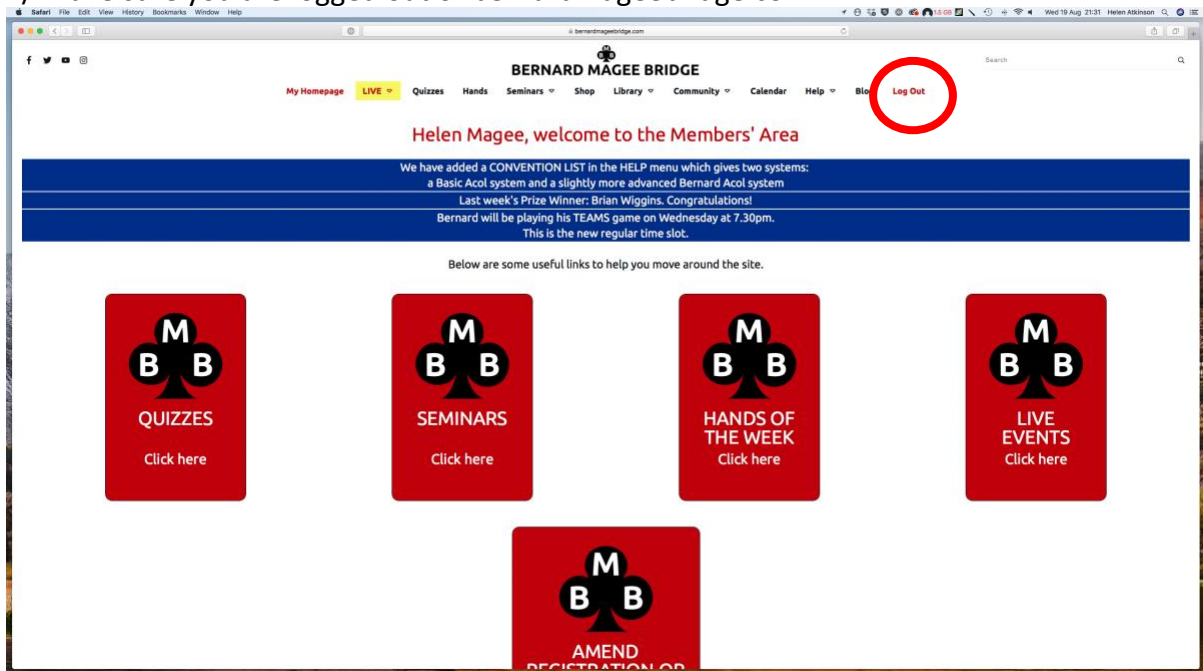

# SAFARI BROWSER on an APPLE MAC COMPUTER

## HOW TO CLEAR THE CACHE:

3/ Select Safari 'Preferences'

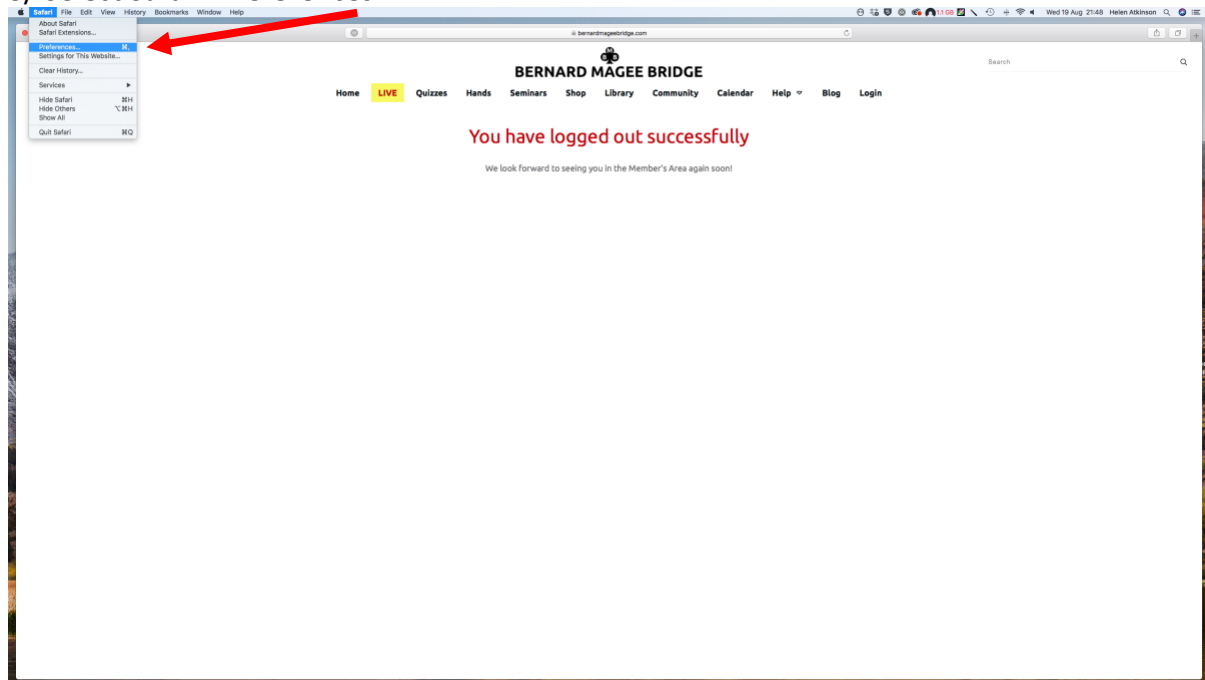

3/ This pop up box comes up. Select 'Privacy'

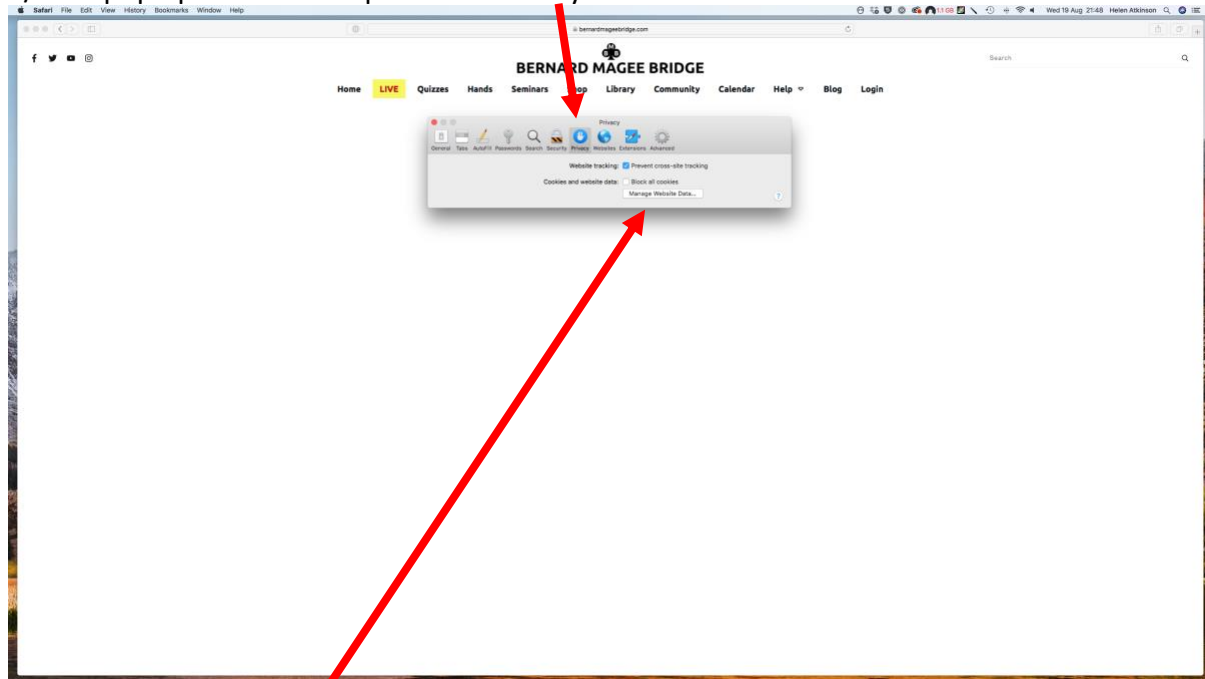

4/ Select 'Manage Website Data...' and wait for pop-up box to load with data

## SAFARI BROWSER on an APPLE MAC COMPUTER

### HOW TO CLEAR THE CACHE:

5/ Wait for this pop up box to load:

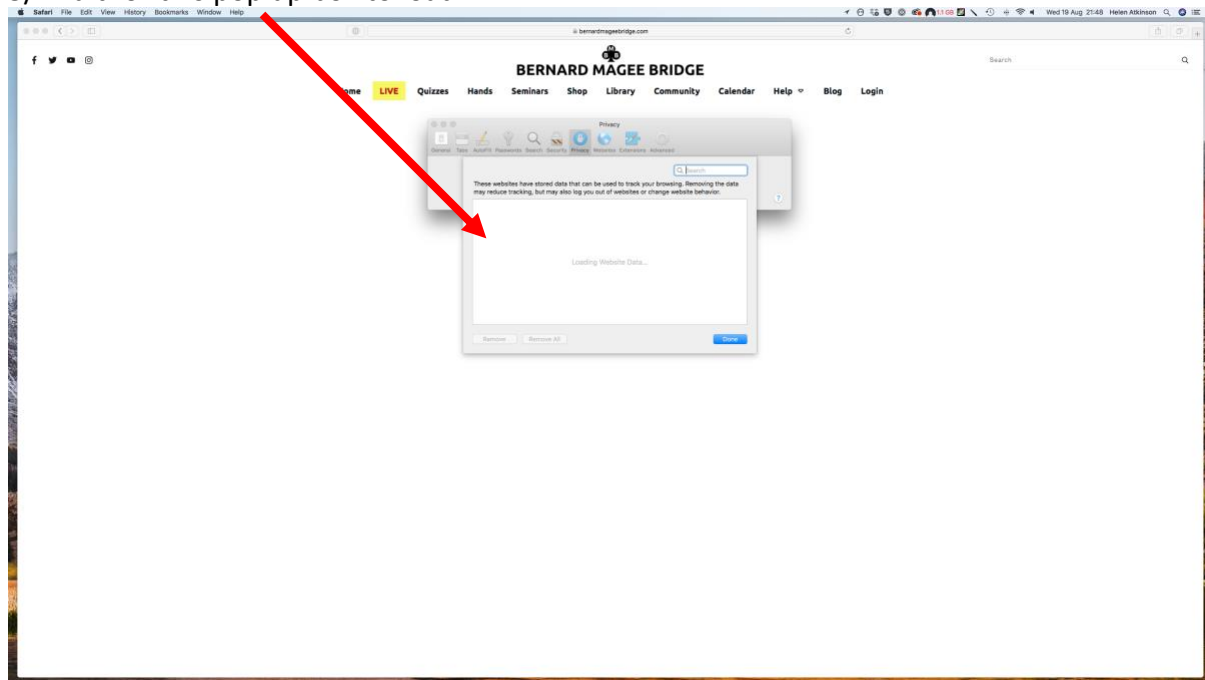

6/ When the data has loaded, scroll to find bernardmageebridge.com and click on it once to select it

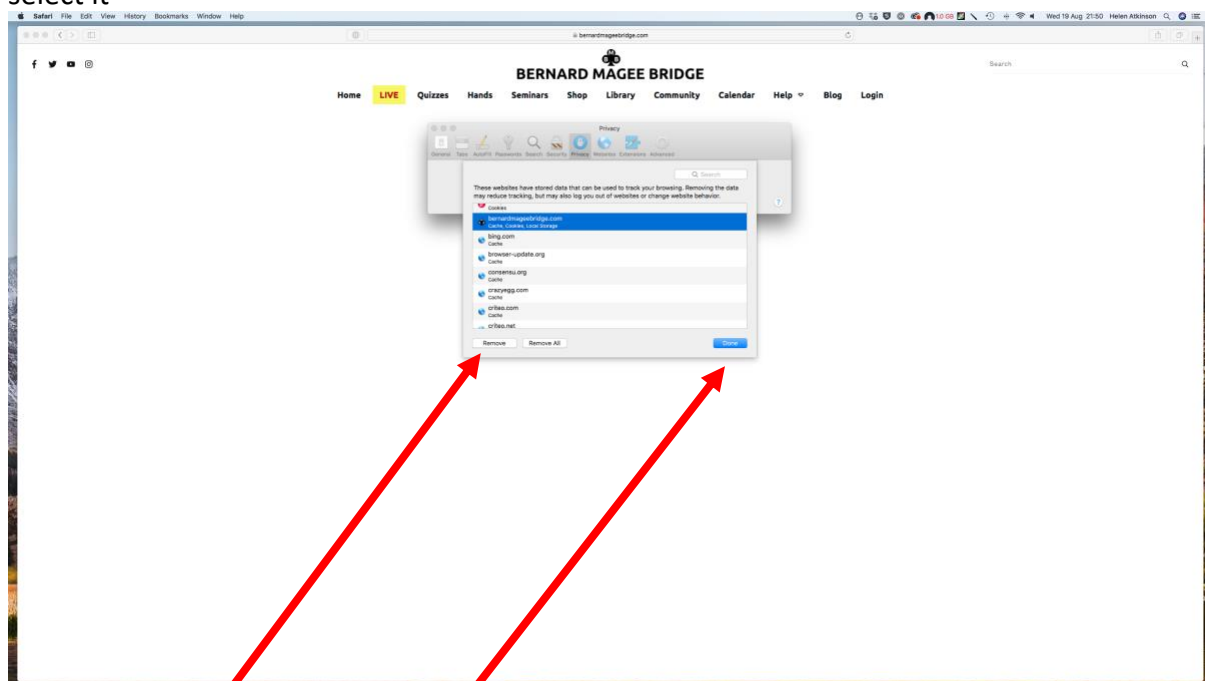

7/ Click 'Remove' then click 'Done' – this will ONLY remove the bernardmageebridge.com from the cache

# SAFARI BROWSER on an APPLE MAC COMPUTER

## HOW TO CLEAR THE CACHE:

8/ Click the small red button to close the box

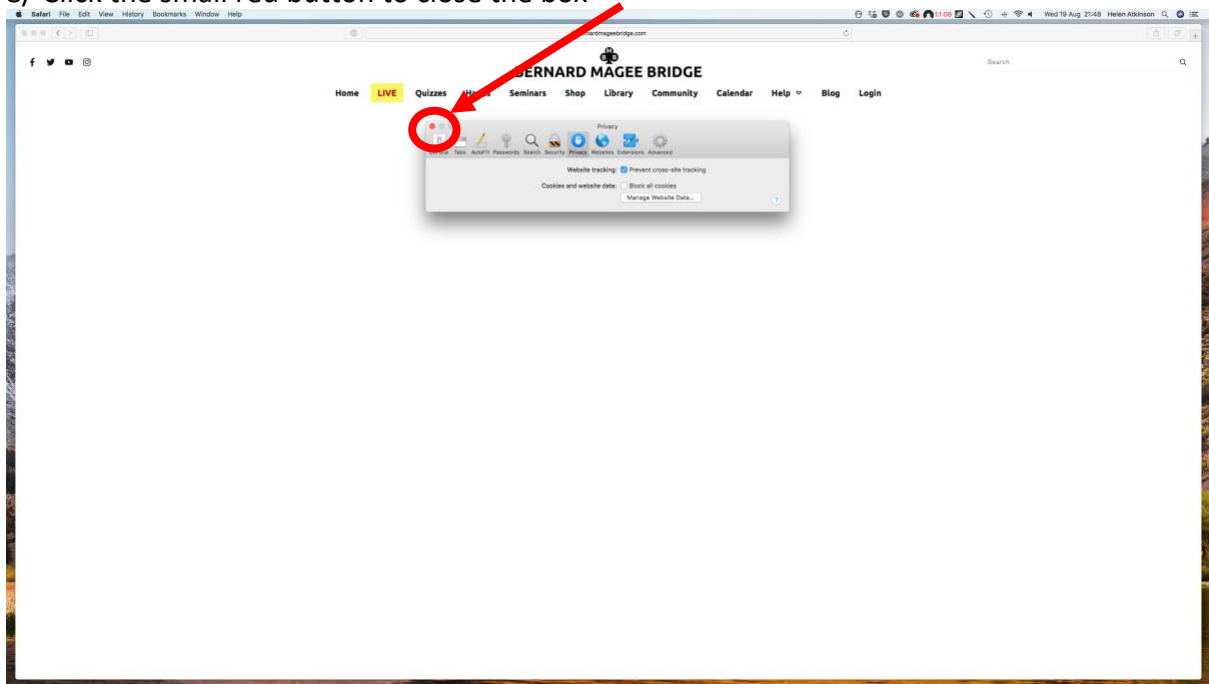

## SAFARI BROWSER on an APPLE MAC COMPUTER

### HOW TO CLEAR THE CACHE:

#### 9/ Quit Safari

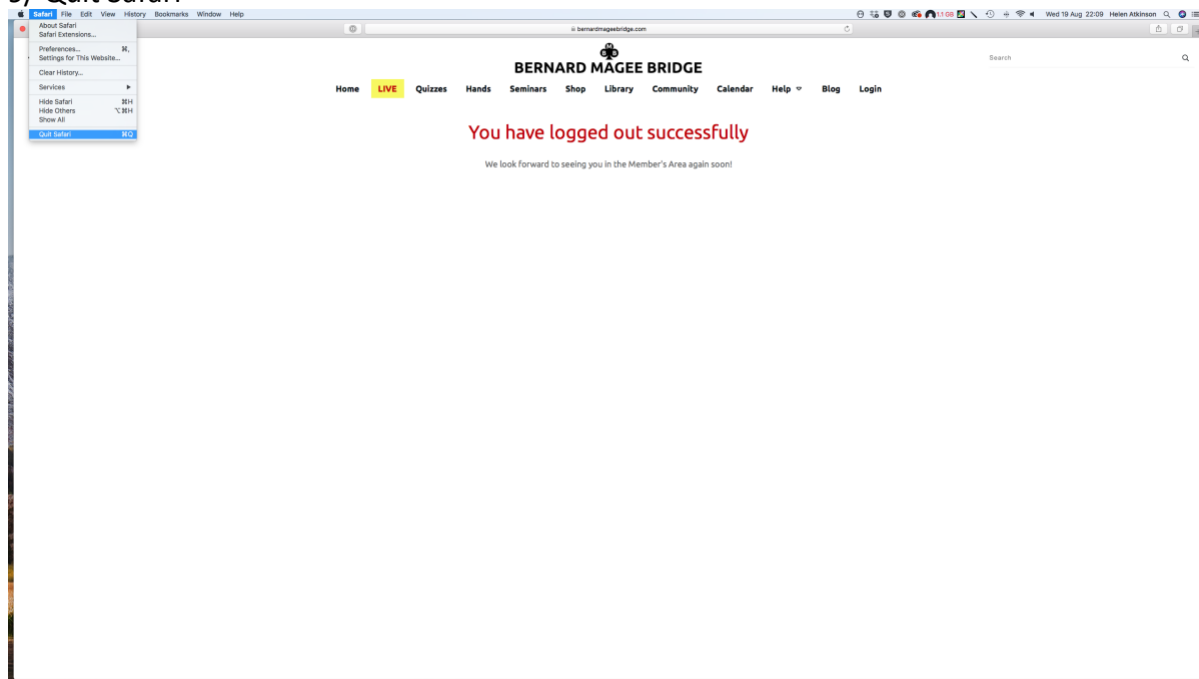

#### 10/ Re-open Safari

#### 11/ Go to bernardmageebridge.com

12/ Click 'OK' to accept cookies for this page [note: if you do not OK this then functionality of this site will be reduced]

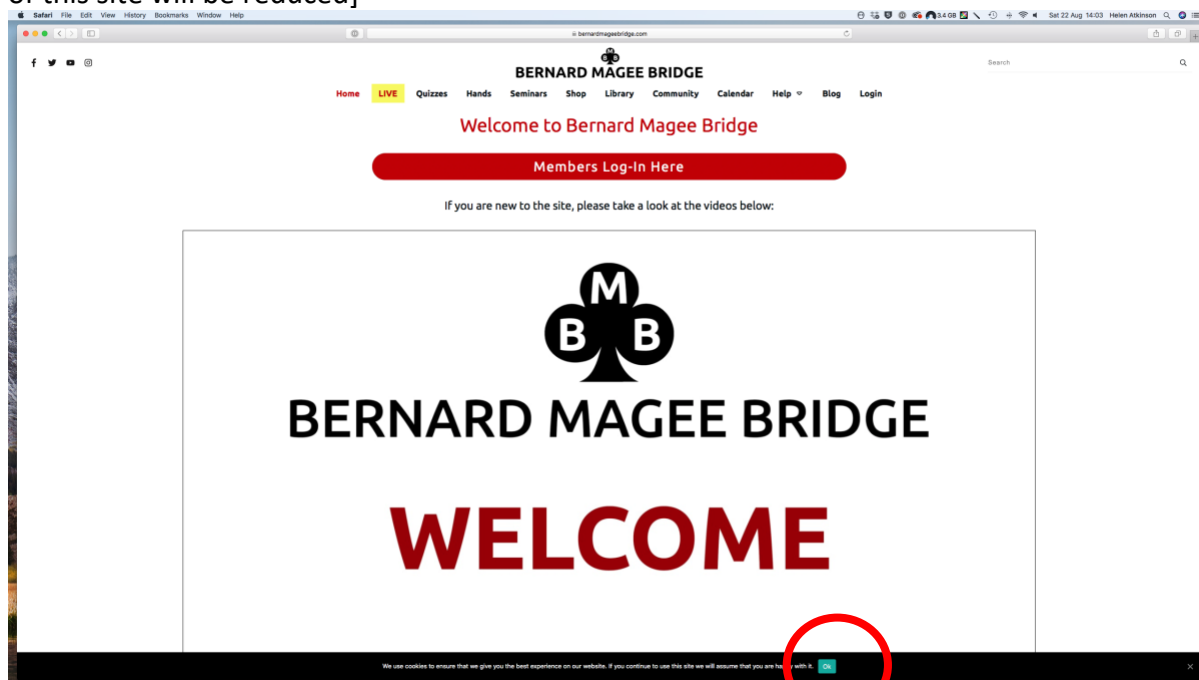

#### 12/ Log-in

SAFARI BROWSER on an APPLE MAC COMPUTER

**HOW TO CLEAR THE CACHE:**

---

END